

SOP #9.3.8A

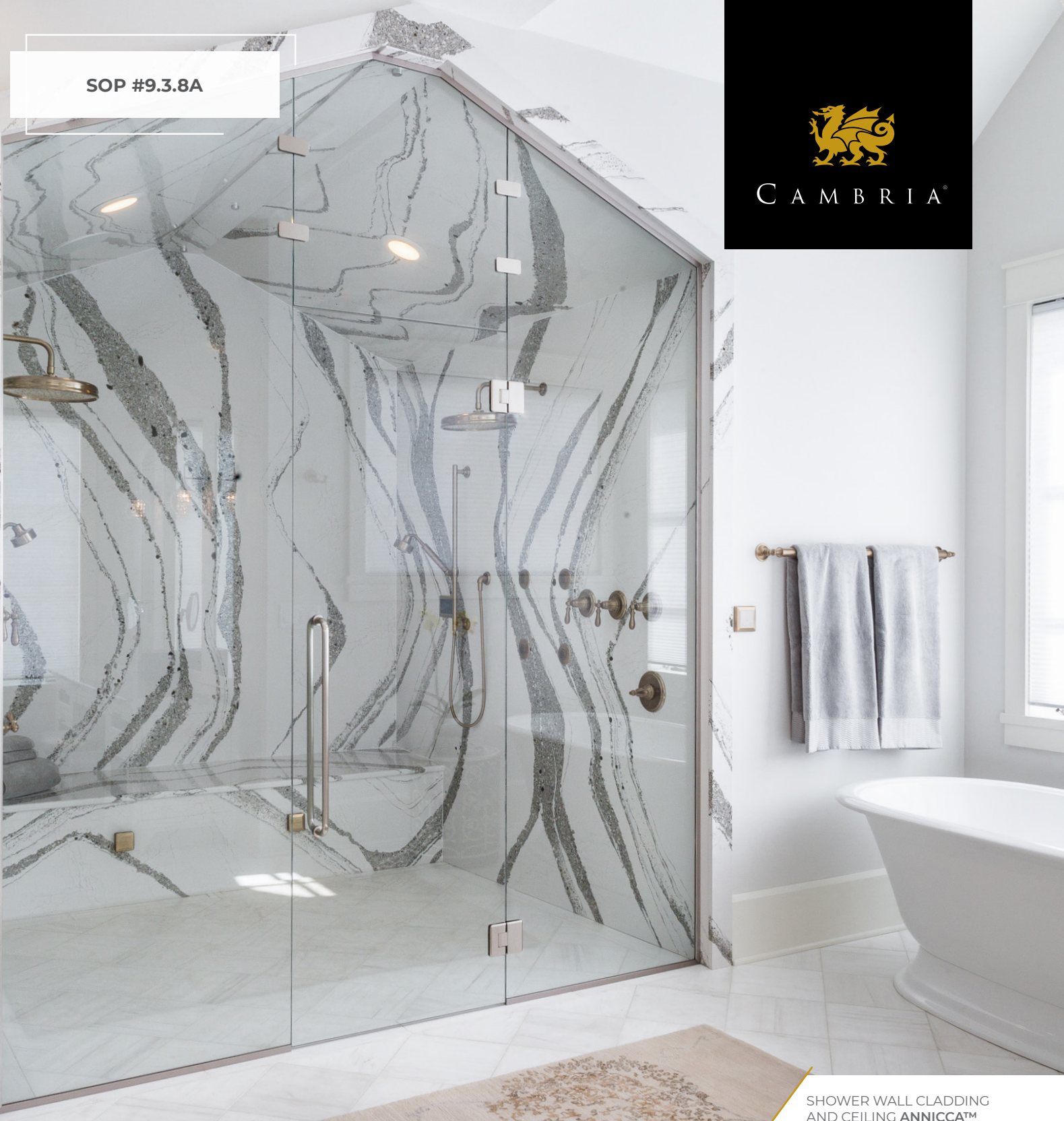

CAMBRIA®



SHOWER WALL CLADDING
AND CEILING ANNICCATI™

INSTALLATION GUIDELINES FOR VERTICAL APPLICATIONS

CAMBRIA AMERICAN-MADE QUARTZ SURFACES

INSTALLATION GUIDELINES FOR VERTICAL APPLICATIONS

SOP #9.3.8A



OBJECTIVE

This document contains information regarding installing Cambria 6mm, 1cm, or 2cm panels to a vertical surface.

NOTE: Cambria is not a structural support material and must be properly adhered to a proper substrate and properly supported by structural support material sufficient to hold the weight of Cambria. This document does not apply to 3cm material.

This procedure is not to be interpreted as all-inclusive regarding the use of Cambria product in vertical applications. It is intended to be evaluated by qualified individuals such as an architect, designer, engineer, general contractor, or other appropriate authority that has the proper knowledge, expertise, authority, and skill to evaluate the information provided and to determine the suitability of Cambria in their project application. Cambria neither assumes nor will accept responsibility, wholly or partly, for any of the design, safety, suitability, or technical needs of the project application.

All bonding agent must be removed immediately from the surface of the Cambria to prevent damage.

VERTICAL APPLICATIONS

1. Each individual panel of Cambria must be installed by bonding Cambria to the backer board.
2. Cambria must be fully supported along the entire bottom length of the Cambria, and the weight of the Cambria must rest solely on this full bottom support. The support material must be sufficient to bear the weight of the Cambria.
 - a. If the Cambria does not rest directly on the floor, a 90 degree angle iron, or substrate, mounted to the wall studs or resting fully on the floor represents a typical full bottom support.
 - b. At least $\frac{2}{3}$ of the thickness of the Cambria material must rest on the full bottom support or floor. See Figures 1 and 2.

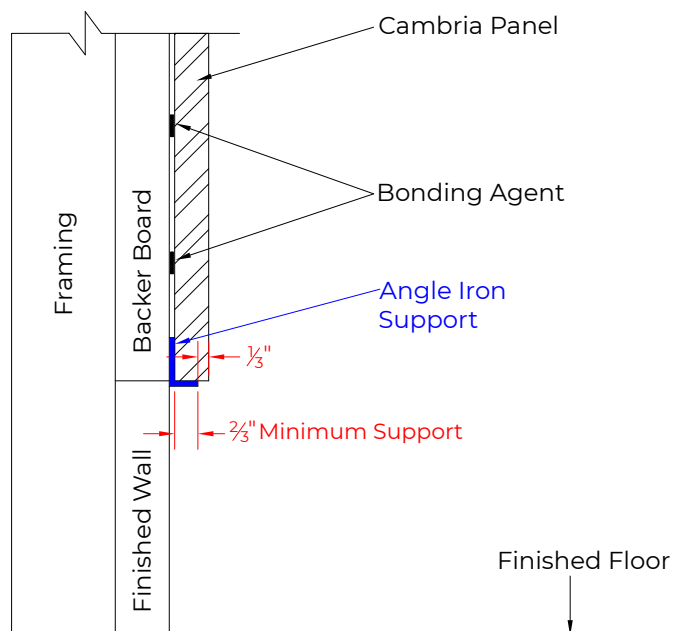

FIGURE 1

Confidential and Proprietary. This Standard Operating Procedure (SOP) and the information contained herein is confidential and proprietary to Cambria Company LLC ("Cambria"). It may not be copied, reproduced, modified, made available, or disclosed without Cambria's prior written consent. This SOP is not all-inclusive. It may not contain all details with respect to a specific application. This SOP may only be used by the intended recipient and recipient's qualified personnel who possess proper knowledge, training, and skill of the technical application; such persons are responsible for the quality, workmanship, safety, and reliability of their work, as well as discretion for other applicable technical needs required for the application. Cambria assumes no responsibility, wholly or partly, for any of the design, safety, or workmanship of any installation and/or fabrication.

Cambria may change this SOP from time to time without notice. Please refer to the CambriaExchange for the most current version at Pro.CambriaUSA.com/SOP. Please contact your Regional Product Representative with any questions.

INSTALLATION GUIDELINES FOR VERTICAL APPLICATIONS

SOP #9.3.8A



C A M B R I A[®]

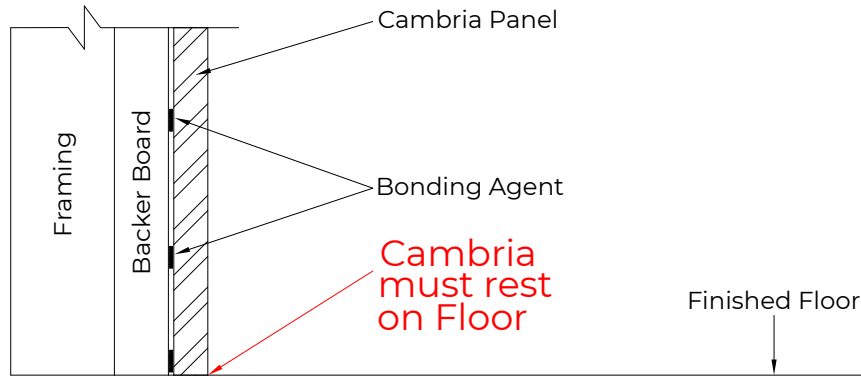

FIGURE 2

- c. Cambria recommends the use of wall anchors or “pucks” to hold the Cambria in a vertical position (not to bear the weight), provided the following are met:
 - i. The anchors must be “slip fit” and not come in direct contact with the Cambria.
 - ii. The weight of the Cambria must not rest on these anchors and/or “pucks.”
- 3. A 1/8" gap must remain between the vertical Cambria panel and the ceiling to allow for expansion of the structure the panel is adhering to. See Figure 3.

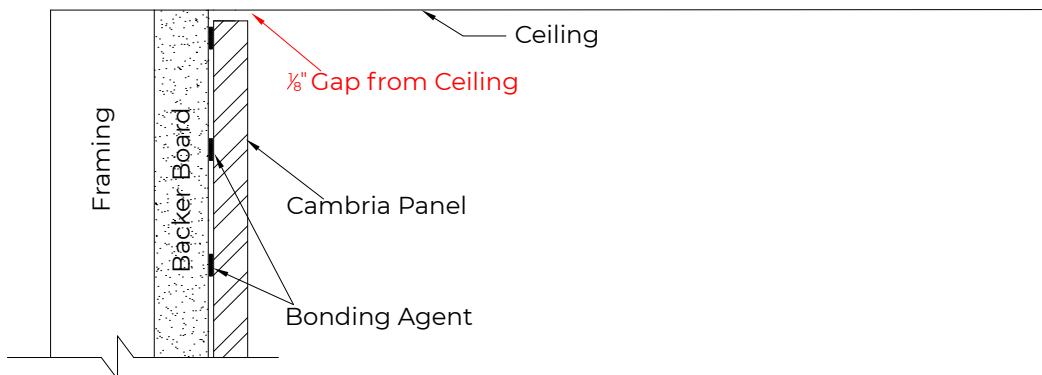

FIGURE 3

Confidential and Proprietary. This Standard Operating Procedure (SOP) and the information contained herein is confidential and proprietary to Cambria Company LLC (“Cambria”). It may not be copied, reproduced, modified, made available, or disclosed without Cambria’s prior written consent. This SOP is not all-inclusive. It may not contain all details with respect to a specific application. This SOP may only be used by the intended recipient and recipient’s qualified personnel who possess proper knowledge, training, and skill of the technical application; such persons are responsible for the quality, workmanship, safety, and reliability of their work, as well as discretion for other applicable technical needs required for the application. Cambria assumes no responsibility, wholly or partly, for any of the design, safety, or workmanship of any installation and/or fabrication.

Cambria may change this SOP from time to time without notice. Please refer to the CambriaExchange for the most current version at Pro.CambriaUSA.com/SOP. Please contact your Regional Product Representative with any questions.

INSTALLATION GUIDELINES FOR VERTICAL APPLICATIONS

SOP #9.3.8A



C A M B R I A[®]

4. All Cambria panels installed vertically must be bonded to the backer board (the backer board must cover 100% of the backside of the Cambria). See Figure 4.

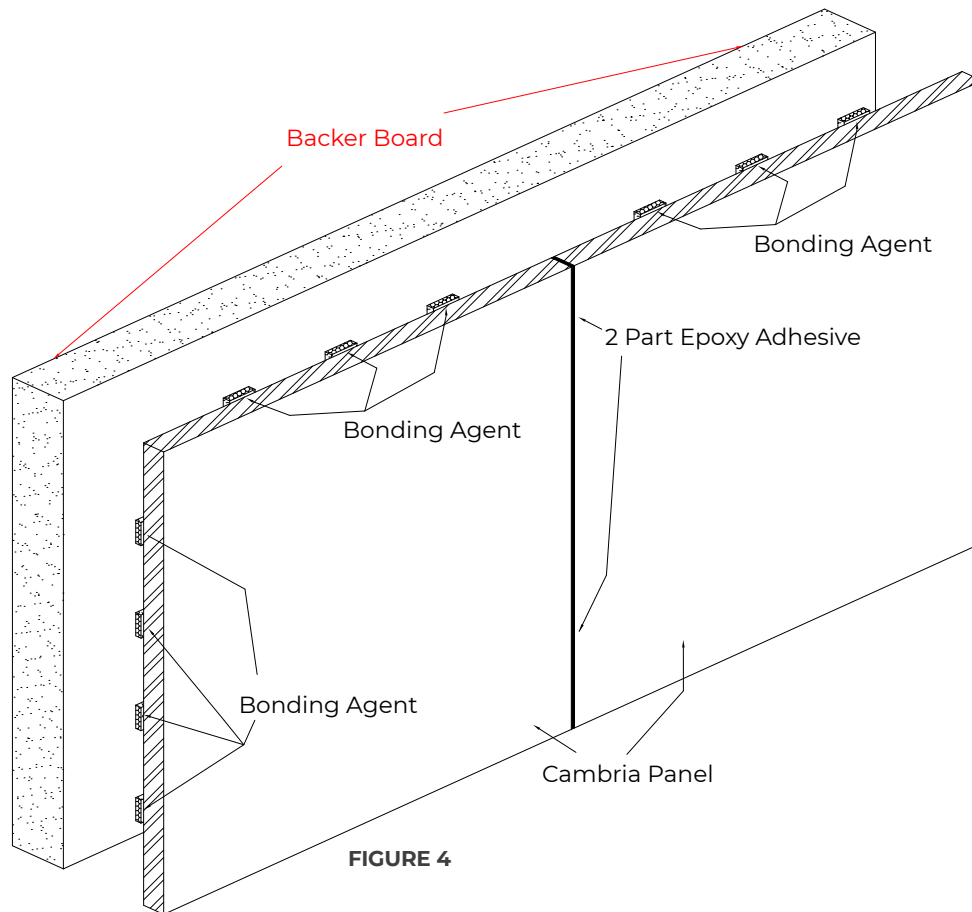

5. Cambria must be bonded to the backer board.
 - a. The surfaces of both the Cambria and the backer board must be clean, dust-free, and dry to provide optimum bond.
 - b. The structure holding the substrate must also be sufficient to support the weight of the Cambria in combination with the structural support requirements.
 - i. If the bonding agent is applied using a trowel it is recommended to thin screed on the back raw face of the Cambria panel before application.
 - c. All seams between the Cambria must be seamed with the 2 part Cambria epoxy. See Figures 5, 6, and 7.

Confidential and Proprietary. This Standard Operating Procedure (SOP) and the information contained herein is confidential and proprietary to Cambria Company LLC ("Cambria"). It may not be copied, reproduced, modified, made available, or disclosed without Cambria's prior written consent. This SOP is not all-inclusive. It may not contain all details with respect to a specific application. This SOP may only be used by the intended recipient and recipient's qualified personnel who possess proper knowledge, training, and skill of the technical application; such persons are responsible for the quality, workmanship, safety, and reliability of their work, as well as discretion for other applicable technical needs required for the application. Cambria assumes no responsibility, wholly or partly, for any of the design, safety, or workmanship of any installation and/or fabrication.

Cambria may change this SOP from time to time without notice. Please refer to the CambriaExchange for the most current version at Pro.CambriaUSA.com/SOP. Please contact your Regional Product Representative with any questions.

INSTALLATION GUIDELINES FOR VERTICAL APPLICATIONS

SOP #9.3.8A



C A M B R I A[®]

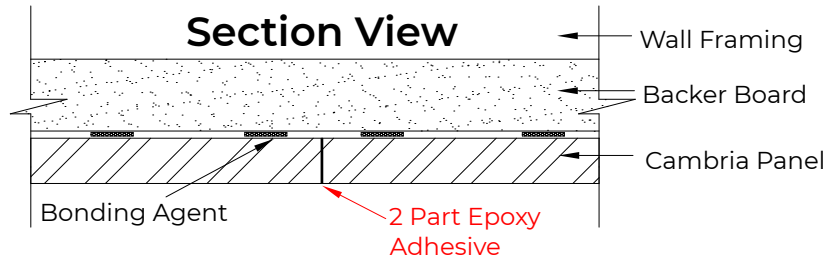

Hard Seam Butt Joint

FIGURE 5

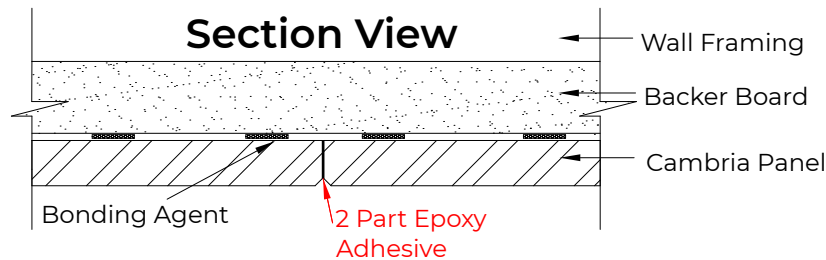

Hard Seam "Eased" Joint

FIGURE 6

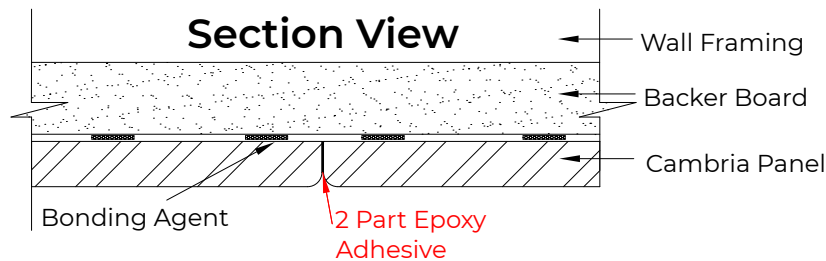

Hard Seam "Half Round" Joint

FIGURE 7

Confidential and Proprietary. This Standard Operating Procedure (SOP) and the information contained herein is confidential and proprietary to Cambria Company LLC ("Cambria"). It may not be copied, reproduced, modified, made available, or disclosed without Cambria's prior written consent. This SOP is not all-inclusive. It may not contain all details with respect to a specific application. This SOP may only be used by the intended recipient and recipient's qualified personnel who possess proper knowledge, training, and skill of the technical application; such persons are responsible for the quality, workmanship, safety, and reliability of their work, as well as discretion for other applicable technical needs required for the application. Cambria assumes no responsibility, wholly or partly, for any of the design, safety, or workmanship of any installation and/or fabrication.

Cambria may change this SOP from time to time without notice. Please refer to the CambriaExchange for the most current version at Pro.CambriaUSA.com/SOP. Please contact your Regional Product Representative with any questions.

INSTALLATION GUIDELINES FOR VERTICAL APPLICATIONS

SOP #9.3.8A



C A M B R I A[®]

- The Cambria must have supplemental support to hold it in place for at least 24 hours while the bonding agent is curing, providing support a minimum of every 36".

CEILING MOLDING

- Ceiling molding is available in 2cm thick material or less.
- The ceiling molding must be adhered using a bonding agent.
 - Apply bonding agent on each end and in the middle of the ceiling molding. See Figure 9
 - There must be a $\frac{1}{16}$ " gap between the ceiling and the ceiling molding to allow for expansion. See Figure 8.
 - Apply a thin bead of silicone along the seam of the ceiling molding and the Cambria panel for the entire length of the ceiling molding. See Figure 8.

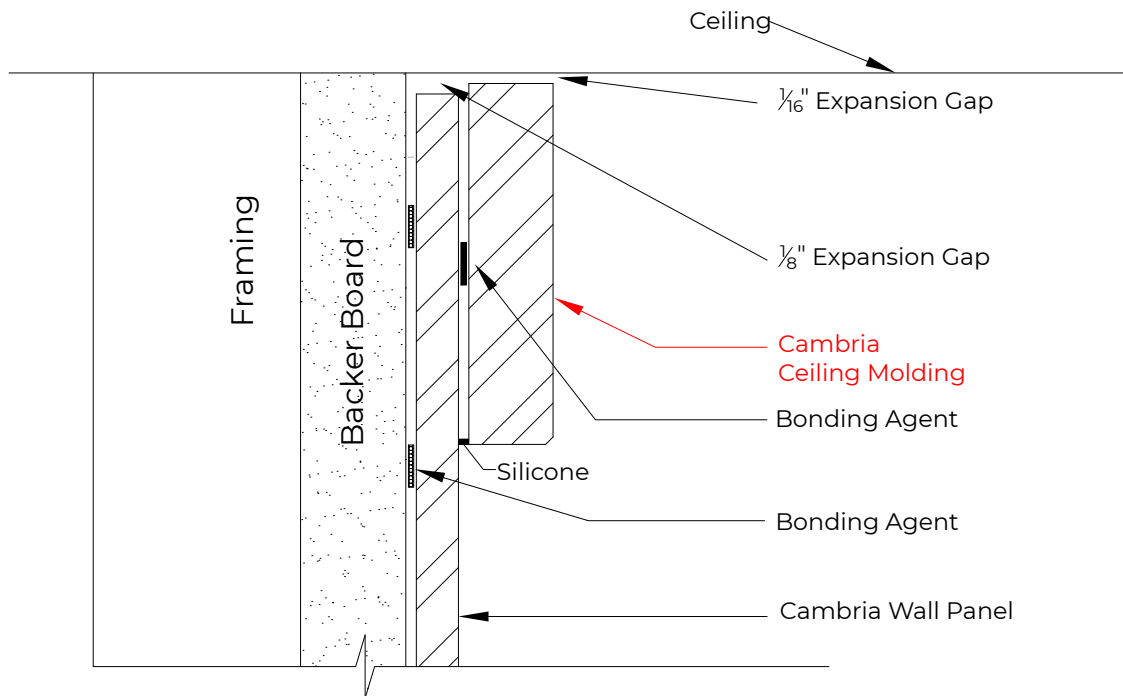

FIGURE 8

Confidential and Proprietary. This Standard Operating Procedure (SOP) and the information contained herein is confidential and proprietary to Cambria Company LLC ("Cambria"). It may not be copied, reproduced, modified, made available, or disclosed without Cambria's prior written consent. This SOP is not all-inclusive. It may not contain all details with respect to a specific application. This SOP may only be used by the intended recipient and recipient's qualified personnel who possess proper knowledge, training, and skill of the technical application; such persons are responsible for the quality, workmanship, safety, and reliability of their work, as well as discretion for other applicable technical needs required for the application. Cambria assumes no responsibility, wholly or partly, for any of the design, safety, or workmanship of any installation and/or fabrication.

Cambria may change this SOP from time to time without notice. Please refer to the CambriaExchange for the most current version at Pro.CambriaUSA.com/SOP. Please contact your Regional Product Representative with any questions.

INSTALLATION GUIDELINES FOR VERTICAL APPLICATIONS

SOP #9.3.8A



BASE MOLDING

9. Base Molding is available in 1cm, 2cm, and 3cm.
10. Base Molding must be adhered using 50-year 100% silicone.
 - a. Apply a dollop of silicone on each end and in the middle of the base molding. See Figure 9.
 - b. A thin bead of silicone should be placed across the top of the base molding where the molding meets the Cambria panel, as well as any pieces that seam together. See Figure 9.

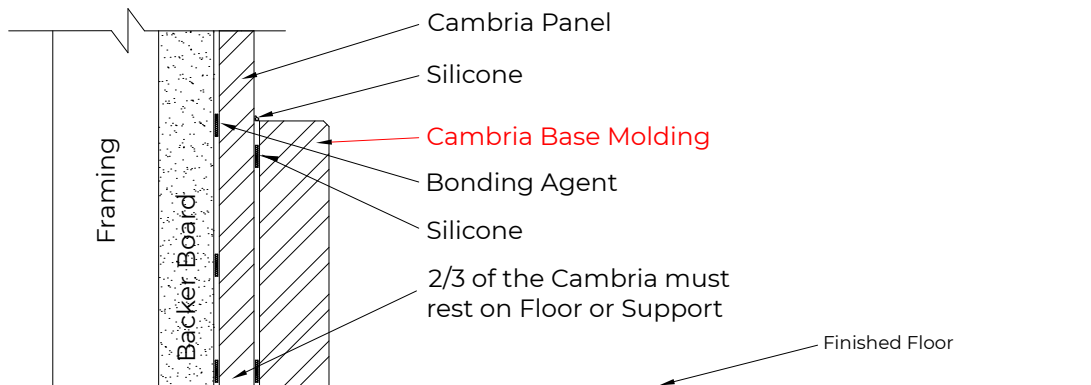

FIGURE 9

Confidential and Proprietary. This Standard Operating Procedure (SOP) and the information contained herein is confidential and proprietary to Cambria Company LLC ("Cambria"). It may not be copied, reproduced, modified, made available, or disclosed without Cambria's prior written consent. This SOP is not all-inclusive. It may not contain all details with respect to a specific application. This SOP may only be used by the intended recipient and recipient's qualified personnel who possess proper knowledge, training, and skill of the technical application; such persons are responsible for the quality, workmanship, safety, and reliability of their work, as well as discretion for other applicable technical needs required for the application. Cambria assumes no responsibility, wholly or partly, for any of the design, safety, or workmanship of any installation and/or fabrication.

Cambria may change this SOP from time to time without notice. Please refer to the CambriaExchange for the most current version at Pro.CambriaUSA.com/SOP. Please contact your Regional Product Representative with any questions.



C A M B R I A[®]



Declare.



LIVING BUILDING CHALLENGE

